

360° MODERN
ARCHITECTURE II

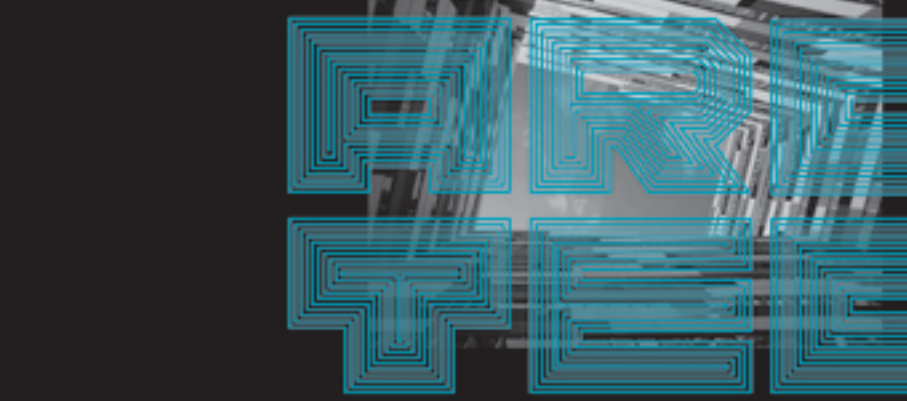
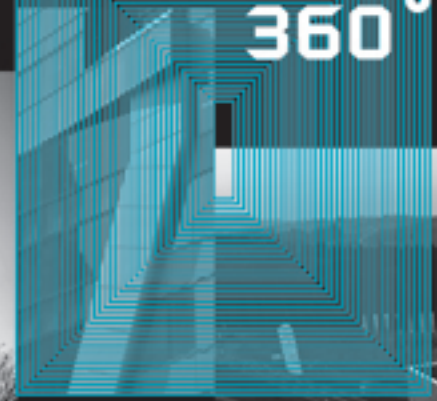

360° MODERN
ARCHITECTURE

Monovolume Architecture + Design

Blaas General Partnership

Floor Area: 1,250m²

Photography: Oskar Da Riz

Mix use



The company Blaas in Bolzano is specialized in electro-mechanics. In the new head office the company presents its new product range and offers repair service.

On the ground floor of the building there is the sales division, on the first floor the exposition area and the repair shop. All administration offices are located on the second floor. The overall impression of the structure is a homogenous and closed building. Nevertheless, there exists a separation between the public and the private sector. The client can perceive this clear and formal internal division already from the outside.

The glass façade on the Northern side provides a maximum of visibility and transparency to the exhibition and sales area. The private spaces such as repair offices, stockrooms and offices have their façades exposed to the South, East and West which are protected with a sun screening system. In order to establish an optimal relation between natural light, development and planning of spaces there has been created a luminous entrance hall in the centre of the building with an inner courtyard. This green open spot permits the administrative sector of the second floor to receive ample natural light and at the same time it generates a protected, quiet recreation area for the staff.

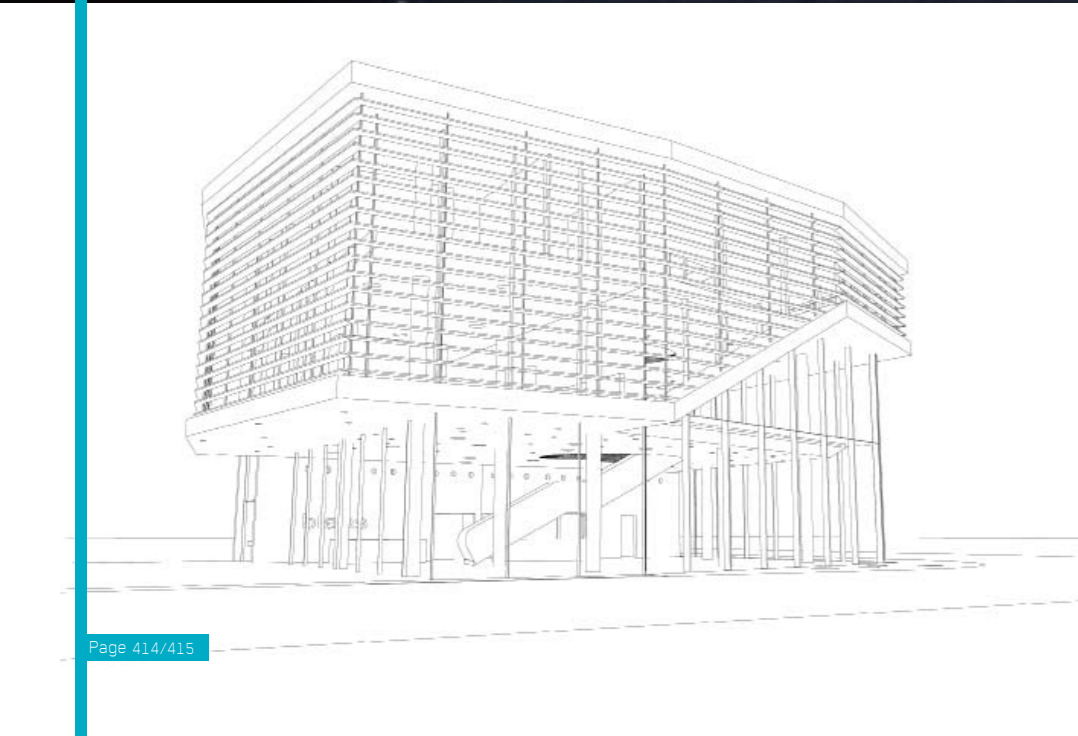





Monovolume Architecture + Design

Rotho Blaas Limited Company

Floor Area: 3,700m²

Photography: Oskar Da Riz

Mix use





[The "Rothoblaas" office is a large-scale commercial operation specializing in assembling systems and power tools for the woodworking industry. Warehouse and commissioning are situated on the ground floor whereas administration, a meeting room and a showroom can be found on the upper floor. The aim of the project was to create a compact building with a high level of recognition. The building was taken as corporate identity of the enterprise; contemporary and representative of the company. This has led to a functional, compact structural shell, provided with a glass envelope. The main building material employed is wood in order to show the own products.](#)



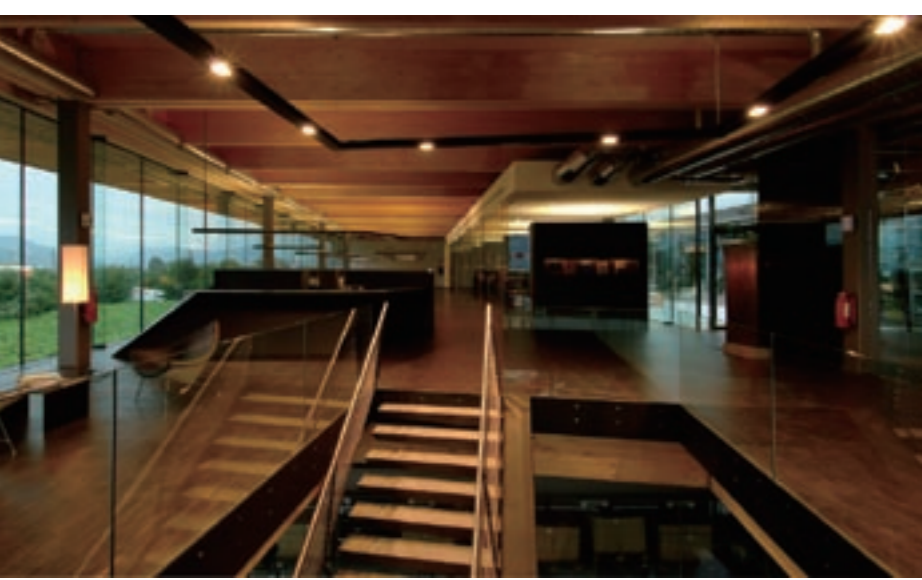

Studio Daniel Libeskind

Westside Brünnen Bern

Floor Area: 150,000m²

Photography: Bitter Bredt Fotografie, Michele Nastasi

Mix use

